

- 1
- 2
- 3
- 4
- 5
- 6
- 7
- 8
- 9
- 10
- 11
- 12
- 13
- 14
- 15
- 16
- 17
- 18

LEVER BODY

Die cast zinc alloy, epoxy resin coating, black colour RAL 9005 (SW) or grey colour RAL 9006 (SR), matte finish.

HUB CAP

Polyamide based (PA) technopolymer black or grey colour.

RETAINING SCREW

AISI 304 stainless steel.

STANDARD EXECUTIONS

AISI 303 stainless steel clamping element.

AISI 302 stainless steel return spring.

- Threaded hole.

- Threaded screw, length as shown in the table.

FEATURES AND APPLICATIONS

GN 126.1 adjustable handles, characterised by their reduced height and elegant design, are particularly suitable for all applications with limited space for manoeuvre.

SPECIAL EXECUTIONS ON REQUEST

Clamping element with plain hole.

INSTRUCTIONS OF USE

For clamping, lift the lever to disengage the clamping device teeth and bring it back to start position. By releasing the lever, the return spring automatically engages the teeth.

If the lever cannot make a 360° rotation, the clamping element can be easily screwed by means of the hexagon socket front head screw (after having disengaged the lever).

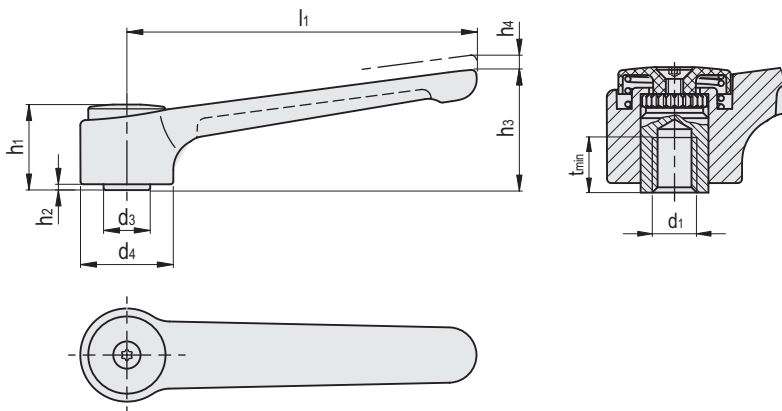

| Conversion Table | |
|-------------------|------|
| 1 mm = 0.039 inch | |
| l1 | |
| mm | inch |
| 120 | 4.72 |
| 145 | 5.71 |

■ SW RAL9005 ■ SR RAL9006

| Code | Description | Code | Description | l1 | d1 | d3 | d4 | h1 | h2 | h3 | h4 | tmin | ⚖️ |
|----------|---------------------|----------|---------------------|-----|-----|----|----|------|----|------|-----|------|-----|
| GN.40593 | GN 126.1-120-M8-SW | GN.40591 | GN 126.1-120-M8-SR | 120 | M8 | 16 | 32 | 29.5 | 2 | 41.5 | 2.5 | 14 | 187 |
| GN.40643 | GN 126.1-120-M10-SW | GN.40641 | GN 126.1-120-M10-SR | 120 | M10 | 16 | 32 | 29.5 | 2 | 41.5 | 2.5 | 14 | 187 |
| GN.40693 | GN 126.1-120-M12-SW | GN.40691 | GN 126.1-120-M12-SR | 120 | M12 | 16 | 32 | 29.5 | 2 | 41.5 | 2.5 | 14 | 187 |
| GN.40753 | GN 126.1-145-M12-SW | GN.40751 | GN 126.1-145-M12-SR | 145 | M12 | 23 | 40 | 42 | 4 | 56 | 4 | 22 | 390 |
| GN.40793 | GN 126.1-145-M16-SW | GN.40791 | GN 126.1-145-M16-SR | 145 | M16 | 23 | 40 | 42 | 4 | 56 | 4 | 22 | 373 |

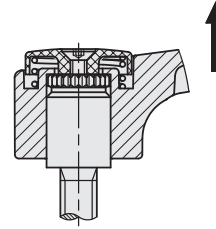
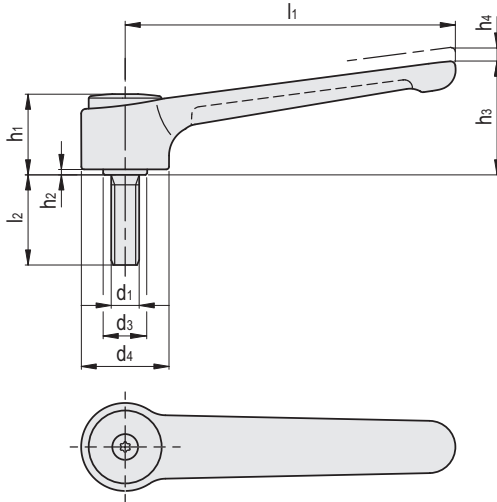

| Conversion Table | |
|-------------------|------|
| 1 mm = 0.039 inch | |
| l1 | |
| mm | inch |
| 120 | 4.72 |
| 145 | 5.71 |

SW RAL9005 SR RAL9006

INOX STAINLESS STEEL METRIC

| Code | Description | Code | Description | l1 | d1 | d3 | d4 | h1 | h2 | h3 | h4 | l2 | ⚖ |
|----------|------------------------|----------|------------------------|-----|-----|----|----|------|----|------|-----|----|-----|
| GN.40603 | GN 126.1-120-M8-12-SW | GN.40601 | GN 126.1-120-M8-12-SR | 120 | M8 | 16 | 32 | 29.5 | 2 | 41.5 | 2.5 | 12 | 159 |
| GN.40607 | GN 126.1-120-M8-16-SW | GN.40605 | GN 126.1-120-M8-16-SR | 120 | M8 | 16 | 32 | 29.5 | 2 | 41.5 | 2.5 | 16 | 214 |
| GN.40611 | GN 126.1-120-M8-20-SW | GN.40609 | GN 126.1-120-M8-20-SR | 120 | M8 | 16 | 32 | 29.5 | 2 | 41.5 | 2.5 | 20 | 198 |
| GN.40615 | GN 126.1-120-M8-25-SW | GN.40613 | GN 126.1-120-M8-25-SR | 120 | M8 | 16 | 32 | 29.5 | 2 | 41.5 | 2.5 | 25 | 200 |
| GN.40619 | GN 126.1-120-M8-32-SW | GN.40617 | GN 126.1-120-M8-32-SR | 120 | M8 | 16 | 32 | 29.5 | 2 | 41.5 | 2.5 | 32 | 202 |
| GN.40623 | GN 126.1-120-M8-40-SW | GN.40621 | GN 126.1-120-M8-40-SR | 120 | M8 | 16 | 32 | 29.5 | 2 | 41.5 | 2.5 | 40 | 205 |
| GN.40627 | GN 126.1-120-M8-50-SW | GN.40625 | GN 126.1-120-M8-50-SR | 120 | M8 | 16 | 32 | 29.5 | 2 | 41.5 | 2.5 | 50 | 208 |
| GN.40631 | GN 126.1-120-M8-63-SW | GN.40629 | GN 126.1-120-M8-63-SR | 120 | M8 | 16 | 32 | 29.5 | 2 | 41.5 | 2.5 | 63 | 211 |
| GN.40653 | GN 126.1-120-M10-16-SW | GN.40651 | GN 126.1-120-M10-16-SR | 120 | M10 | 16 | 32 | 29.5 | 2 | 41.5 | 2.5 | 16 | 200 |
| GN.40657 | GN 126.1-120-M10-20-SW | GN.40655 | GN 126.1-120-M10-20-SR | 120 | M10 | 16 | 32 | 29.5 | 2 | 41.5 | 2.5 | 20 | 202 |
| GN.40661 | GN 126.1-120-M10-25-SW | GN.40659 | GN 126.1-120-M10-25-SR | 120 | M10 | 16 | 32 | 29.5 | 2 | 41.5 | 2.5 | 25 | 204 |
| GN.40665 | GN 126.1-120-M10-32-SW | GN.40663 | GN 126.1-120-M10-32-SR | 120 | M10 | 16 | 32 | 29.5 | 2 | 41.5 | 2.5 | 32 | 207 |
| GN.40669 | GN 126.1-120-M10-40-SW | GN.40667 | GN 126.1-120-M10-40-SR | 120 | M10 | 16 | 32 | 29.5 | 2 | 41.5 | 2.5 | 40 | 212 |
| GN.40673 | GN 126.1-120-M10-50-SW | GN.40671 | GN 126.1-120-M10-50-SR | 120 | M10 | 16 | 32 | 29.5 | 2 | 41.5 | 2.5 | 50 | 217 |
| GN.40677 | GN 126.1-120-M10-63-SW | GN.40675 | GN 126.1-120-M10-63-SR | 120 | M10 | 16 | 32 | 29.5 | 2 | 41.5 | 2.5 | 63 | 224 |
| GN.40681 | GN 126.1-120-M10-80-SW | GN.40679 | GN 126.1-120-M10-80-SR | 120 | M10 | 16 | 32 | 29.5 | 2 | 41.5 | 2.5 | 80 | 231 |
| GN.40703 | GN 126.1-120-M12-20-SW | GN.40701 | GN 126.1-120-M12-20-SR | 120 | M12 | 16 | 32 | 29.5 | 2 | 41.5 | 2.5 | 20 | 206 |
| GN.40707 | GN 126.1-120-M12-25-SW | GN.40705 | GN 126.1-120-M12-25-SR | 120 | M12 | 16 | 32 | 29.5 | 2 | 41.5 | 2.5 | 25 | 210 |
| GN.40711 | GN 126.1-120-M12-32-SW | GN.40709 | GN 126.1-120-M12-32-SR | 120 | M12 | 16 | 32 | 29.5 | 2 | 41.5 | 2.5 | 32 | 215 |
| GN.40715 | GN 126.1-120-M12-40-SW | GN.40713 | GN 126.1-120-M12-40-SR | 120 | M12 | 16 | 32 | 29.5 | 2 | 41.5 | 2.5 | 40 | 221 |
| GN.40719 | GN 126.1-120-M12-50-SW | GN.40717 | GN 126.1-120-M12-50-SR | 120 | M12 | 16 | 32 | 29.5 | 2 | 41.5 | 2.5 | 50 | 228 |
| GN.40723 | GN 126.1-120-M12-63-SW | GN.40721 | GN 126.1-120-M12-63-SR | 120 | M12 | 16 | 32 | 29.5 | 2 | 41.5 | 2.5 | 63 | 237 |
| GN.40727 | GN 126.1-120-M12-80-SW | GN.40725 | GN 126.1-120-M12-80-SR | 120 | M12 | 16 | 32 | 29.5 | 2 | 41.5 | 2.5 | 80 | 249 |
| GN.40763 | GN 126.1-145-M12-25-SW | GN.40761 | GN 126.1-145-M12-25-SR | 145 | M12 | 23 | 40 | 42 | 4 | 56 | 4 | 25 | 440 |
| GN.40767 | GN 126.1-145-M12-32-SW | GN.40765 | GN 126.1-145-M12-32-SR | 145 | M12 | 23 | 40 | 42 | 4 | 56 | 4 | 32 | 432 |
| GN.40771 | GN 126.1-145-M12-40-SW | GN.40769 | GN 126.1-145-M12-40-SR | 145 | M12 | 23 | 40 | 42 | 4 | 56 | 4 | 40 | 440 |
| GN.40775 | GN 126.1-145-M12-50-SW | GN.40773 | GN 126.1-145-M12-50-SR | 145 | M12 | 23 | 40 | 42 | 4 | 56 | 4 | 50 | 447 |
| GN.40779 | GN 126.1-145-M12-63-SW | GN.40777 | GN 126.1-145-M12-63-SR | 145 | M12 | 23 | 40 | 42 | 4 | 56 | 4 | 63 | 455 |
| GN.40783 | GN 126.1-145-M12-80-SW | GN.40781 | GN 126.1-145-M12-80-SR | 145 | M12 | 23 | 40 | 42 | 4 | 56 | 4 | 80 | 445 |
| GN.40803 | GN 126.1-145-M16-32-SW | GN.40801 | GN 126.1-145-M16-32-SR | 145 | M16 | 23 | 40 | 42 | 4 | 56 | 4 | 32 | 449 |
| GN.40807 | GN 126.1-145-M16-40-SW | GN.40805 | GN 126.1-145-M16-40-SR | 145 | M16 | 23 | 40 | 42 | 4 | 56 | 4 | 40 | 460 |
| GN.40811 | GN 126.1-145-M16-50-SW | GN.40809 | GN 126.1-145-M16-50-SR | 145 | M16 | 23 | 40 | 42 | 4 | 56 | 4 | 50 | 472 |
| GN.40815 | GN 126.1-145-M16-63-SW | GN.40813 | GN 126.1-145-M16-63-SR | 145 | M16 | 23 | 40 | 42 | 4 | 56 | 4 | 63 | 491 |
| GN.40819 | GN 126.1-145-M16-80-SW | GN.40817 | GN 126.1-145-M16-80-SR | 145 | M16 | 23 | 40 | 42 | 4 | 56 | 4 | 80 | 513 |



Clamping handles